

NOTES:

UNLESS OTHERWISE SPECIFIED:

1. **CAD:** USE ZT-HWA-00184(01).DXF FOR TOOLING AND MANUFACTURE. THIS DRAWING WAS GENERATED FROM A CAD DATABASE. QUERY CAD FILE FOR BASIC DIMENSIONS. IF A CONFLICT EXISTS BETWEEN THIS DOCUMENT AND ANY REFERENCED DOCUMENT, THIS ONE TAKES PRECEDENCE.
2. **DIMENSIONING:** ALL DIMENSIONS ARE IN MM. DIMENSIONING AND TOLERANCING ARE PER ASME Y14.5-1994.
3. **TOLERANCES:** UNLESS OTHERWISE STATED, FEATURE SIZE AND POSITIONAL TOLERANCES ARE AS FOLLOWS:
 - X ± 0.50 MM
 - X.X ± 0.50 MM
 - X.XX ± 0.50 MM
 - ANGLES ± 2°
 - ALL BEND POSITIONS: ± 0.50 MM
4. **MATERIAL:** ALUMINUM, 2MM THICK STOCK, TYPE 5052-H32
5. **FINISH:** SAND BLAST AND BLACK ANODIZE.
6. **PART CLEANINESS:** REMOVE ALL BURRS & SHARP CORNERS. CLEAN OFF ALL OILS, DIRT, OR OTHER CONTAMINANTS
7. **INSPECTION DIMENSIONS:** DIMENSIONS IN OVALS SHALL BE INSPECTED AT INCOMING INSPECTION.
8. **RoHS COMPLIANCE:** THIS COMPONENT SHALL COMPLY WITH THE EU 2002/95/EC (RoHS) AND EU 2002/96/EC (WEEE) DIRECTIVES
9. **CONTROLLED DRAWING:** NO CHANGES TO THIS DRAWING ALLOWED WITHOUT PRIOR APPROVAL FROM ZT AUTOMATIONS, LLC

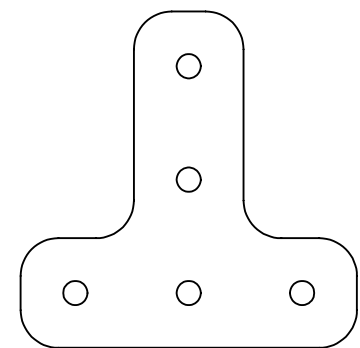
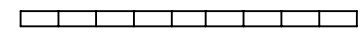
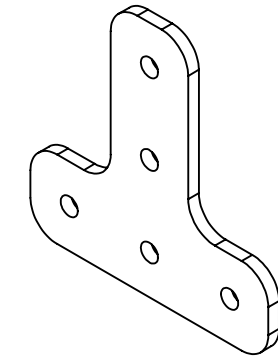

<p>LICENSED UNDER CREATIVE COMMONS CC BY-SA</p> <p>The information in this drawing is licensed under Creative Commons Attribution-Share Alike License. You may freely redistribute the content in this document and share it with others as long as the following criterias are met:</p> <p>1) The author of the document shall be credited as: ZT Automations, LLC - www.ztautomations.com 2) Any changes that are made to this document shall be licensed under the same terms as this document (Creative Commons Attribution Share-Alike) with the original author credited.</p> <p>For more details, please visit Creative Commons at www.CreativeCommons.org/licenses/</p>		<p>TOLERANCES:</p> <p>REFER TO NOTES FOR TOLERANCE INFORMATION.</p>	<p>TITLE:</p> <p>Sheet Metal, T Bracket, OpenBeam 1515</p>		
<p>SIZE:</p> <p>B</p>	<p>ENGINEER:</p> <p>Terence T.S. Tam (譚德成)</p>	<p>PART NUMBER:</p> <p>ZT-HWA-00184</p>	<p>REV</p> <p>01</p>		
<p>DATE CREATED:</p>		<p>DRAWN BY:</p> <p>Terence T.S. Tam (譚德成)</p>			

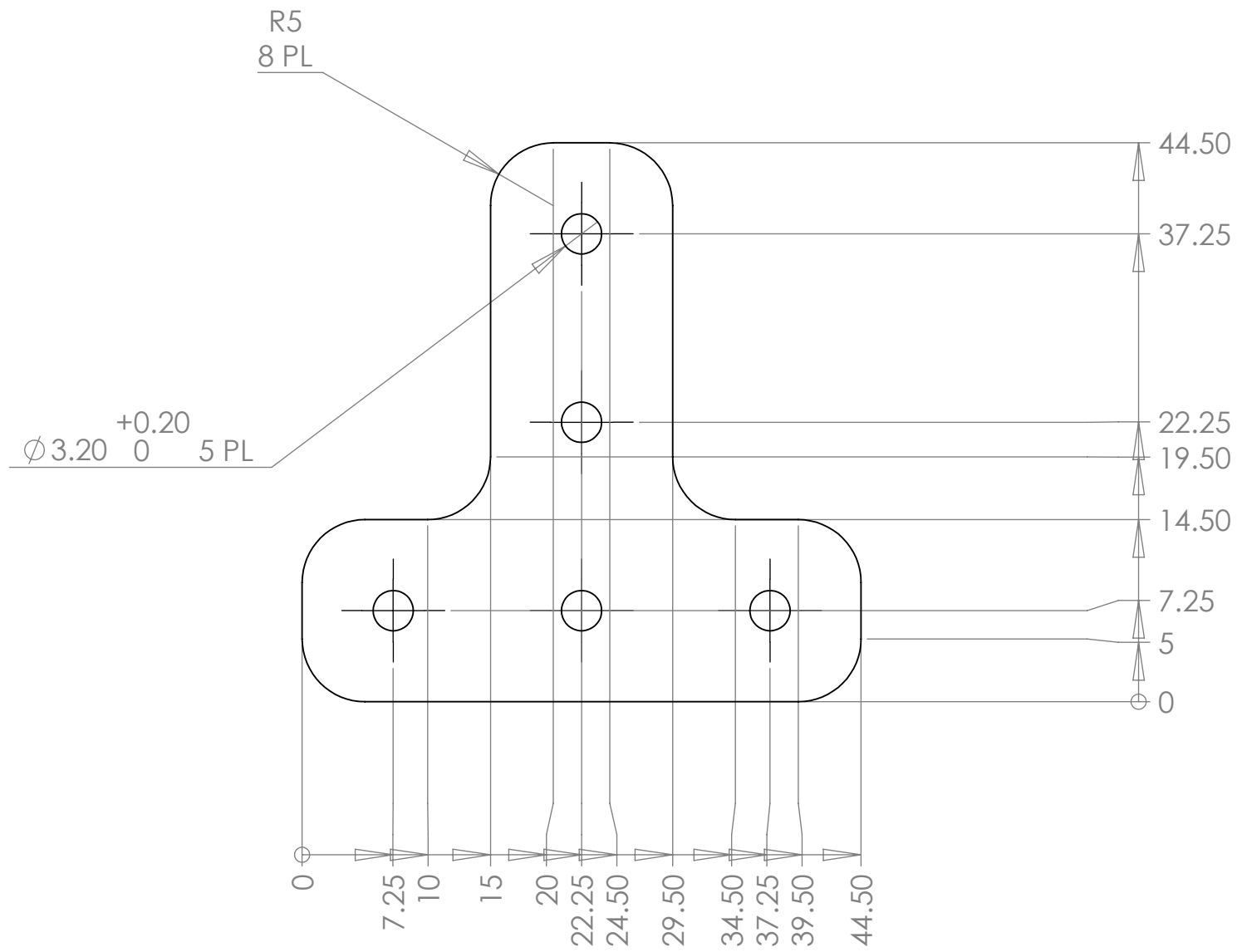
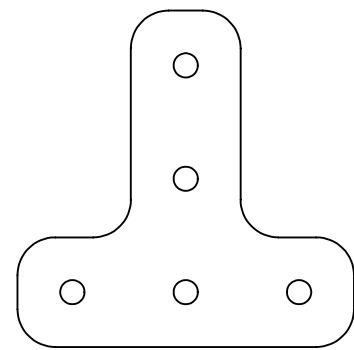

LICENSED UNDER CREATIVE COMMONS CC BY-SA The information in this drawing is licensed under Creative Commons Attribution-Share Alike License. You may freely redistribute the content in this document and share it with others as long as the following criterias are met: 1) The author of the document shall be credited as: ZT Automations, LLC - www.ztautomations.com 2) Any changes that are made to this document shall be licensed under the same terms as this document (Creative Commons Attribution Share-Alike) with the original author credited. For more details, please visit Creative Commons at www.CreativeCommons.org/licenses/		TOLERANCES: REFER TO NOTES FOR TOLERANCE INFORMATION.	TITLE: Sheet Metal, T Bracket, OpenBeam 1515	
SIZE: B		ENGINEER: Terence T.S. Tam (譚德成)	PART NUMBER: ZT-HWA-00184	REV 01
CAD: SOLIDWORKS SCALE: 1:1 FILE NAME: ZT-HWA-00184(01) - Sheet Metal, T Bracket, OpenBeam 1515		DRAWN BY: Terence T.S. Tam (譚德成)	DATE CREATED:	SHEET 2 OF 2